

Ordered to record whereupon Charles H Lambin and Sarah Lambin two of the executors therein named came into court and took the oath prescribed by law and executed and acknowledged bond in the penalty of \$11000 with Ephraim Jann - ary Robert Black and John Scott their sureties conditioned according to law Probate is thereupon granted in due form of law with leave for the other Executor to qualify.

Teste John McKenny J. C. D.

Inventory of Hicks Estate
October 9th 1812 An estimate of the personal property of William Hicks deceased
In pursuance of an order from the worshipful Court of Woodford County to us directed & is as follows viz

One negro Bel aged 55	-	-	250	-
One negro woman named Sen aged 38	-	-	250	-
One negro woman named Sal anochito aged 19	-	-	400	-
One negro woman named Easter aged 17	-	-	350	-
One negro boy named John aged 14	-	-	305	-
One negro boy named Parker aged 12	-	-	325	-
One negro boy named George aged 10	-	-	250	-
One negro boy named Reuben aged 8	-	-	175	-
One negro girl named Beck aged 6	-	-	100	-
One negro boy named Charles aged 1	-	-	75	-
One negro woman named Venia aged 55	-	-	200	-
One negro woman named Sharlot aged 20	-	-	375	-
One negro girl named Mariah aged 12	-	-	300	-
One negro girl named Mary aged 10	-	-	300	-
One negro boy named Tom aged 15	-	-	375	-
One negro man named Doctor aged 35	-	-	450	-
One negro man named Balib aged 30	-	-	300	-
One negro man named Joseph aged 20	-	-	450	-
One negro woman named Fial aged 65	-	-	100	-

31

One negro man named Robert age 26	-	-	200	-
One negro man named Sam age 15	-	-	300	-
One negro woman named Judy age 22	-	-	350	-
One negro boy named Isaac age 1	-	-	100	-
One negro boy named Hudson age 6	-	-	150	-
One negro boy named Daniel age 4	-	-	80	-
One negro boy named Sam age 2	-	-	80	-
One negro boy named Robert age 8	-	-	150	-
One negro boy named Isaac age 11	-	-	250	-
One bay mare age 7	-	-	30	-
One gray mare age 11	-	-	40	-
One bay horse age 18	-	-	20	-
One sorrel mare and colt age 11	-	-	60	-
One bay horse age 6	-	-	30	-
One sorrel horse age 11	-	-	40	-
One brown horse age 7	-	-	20	-
One black mare age 4	-	-	25	-
One bay horse horse age 5	-	-	80	-
One bay mare with a hump back 9	-	-	20	-
One gray mare age 3	-	-	40	-
One bay horse age 1	-	-	20	-
One bay mare age 5	-	-	10	-
One sorrel horse age 2	-	-	25	-
One sorrel horse age 2	-	-	35	-
One sorrel horse age 1	-	-	1	-
One crosscut saw	-	-	10	-
One ax cast	-	-	20	-
One log chain	-	-	4	-
One iron yoke	-	-	1	30
One yoke of sters	-	-	50	-
One waggon	-	-	50	-
One ground stone	-	-	1	-
Two pair of gears	-	-	20	-
Two pair of gears	-	-	12	-

32	Sold old chains and hammers	\$3	-
	Ten mading hoes and one grub hoe	8	-
	Nine axes	12	-
	Black Smith tools	75	-
	One shovel	1	25
	Two wedges	1	25
	Carpenters tools	14	00
	Nineteen files	4	50
	Old Irons	1	-
	Two hundred and fifty weight of Iron	25	-
	Old Irons	3	-
	Seven scythe blades and one cradler	6	-
	Two double trees	0	75
	Three harrows	12	-
	Three plows	9	-
	Three plows	9	-
	One Reaultor	0	75
	One pair of Stuyvesant	6	00
	Nine cows one bull and two calves	120	-
	Three calves	8	50
	Two steers	55	-
	Two do	35	-
	Two white face steers	16	-
	One steer and hisifer	8	-
	Two steers	20	-
	One steer and hisifer	7	-
	Two steers	37	50
	Two steers	28	-
	Two steers	32	-
	One hundred and eighty six hogs	650	-
	Fifty five sheep	82	50
	Two skils and one boiler	178	33
	Twenty three tubs	18	-
	Six hemp breaks	6	-
	Ten bark	2	-
	Six stacks of Rye	65	-

33	Sheaf of oats	20	00
	A quantity of wheat	25	-
	One wheat fan	10	-
	Three tubs	3	75
	Eighteen bushels of Rye	6	-
	Oats hay and fodder	80	-
	Thirteen stacks of wheat	125	-
	Eight Reeds and nine pair gears	15	-
	Room swifts and two quill wheels	12	-
	Oats at William blarkes	50	-
	Twenty acres of corn	420	-
	Four double barrels	8	-
	Three single barrels	3	-
	Warping mill and spool frame	1	50
	Seantling	2	-
	Sheating plank	3	-
	Seantling	1	50
	Staves and heading	20	-
	Machinery works	275	-
	Four hachles	16	-
	Six little wheels	14	-
	Old pump	2	-
	Two big wheels	4	50
	Twenty spools	0	75
	Two cut reels	1	50
	One Table	1	50
	One single barrel	0	75
	Eight double barrels	16	-
	One pickling cag and four starr	2	75
	Three basons two dishes and one plate	6	-
	Six Kettles	18	-
	Three pots and three pair of Pot hooks	5	-
	One brass kettle	3	-
	One frying pan, shovel and two smoothing Irons	2	50

One table	9	50
Three Basins and one plate	4	-
One churn	0	75
Twenty two bags	10	-
One cupboard	2	-
Four barrels	0	25
Six do do	0	75
Hemp seed	2	50
Two fat turts and two barrels	1	-
Old plunder	3	50
One tea kettle	2	-
Six acres of corn	36	-
One bed and furniture	30	-
One do do	25	-
One bundle bed and furniture	18	-
Hand Irons and poaker	2	-
Band stands	0	75
Seventeen chairs	6	-
Six Windsor chairs	4	-
One small Table & water stand	1	-
One sugar dish	6	-
One folding Table	6	-
Two cricks	0	75
Three Irons	1	25
One bed and furniture	35	-
Carpet	4	-
Six baking pans sh. & candlesticks &c	2	-
One carpet	4	-
Cupboard furniture	20	-
Six large spoons and twelve small ones	30	-
One folding Table	6	-
One clock and case	75	-
One cupboard	8	-
One Desk	20	-
One looking glass	50	50

35 One bureau and book case	22	50
Five old book	1	-
One shot gun	6	-
One chest	1	50
One bed and furniture	28	-
One do do	28	-
One do do	30	-
One do do	30	-
One do do	30	-
Four beaver heads	20	-
Three blankets	9	-
Twelve shirts	24	-
Four bed quilts	16	-
Two counterpins	6	-
Two counterpins	14	-
One bed quilt	2	-
One saddle	8	-
one book	1	-
one sorrel mare age 11	60	-
Property belonging to Philemon Price		
One loom	6	66
Two little steers	11	-
Two hogs	3	75
One cow and calf	10	-
One pot	2	-
One frying pan	1	50
Two flat Irons	1	50
One cupboard	10	-
One half dozen plates	1	-
One half dozen cups and saucers	-	75
one tea pot	-	75
One salver and three tumblers	-	75
Two pewter dishes	3	50
Two pewter basins	4	-
half dozen knives and forks	2	50
One pair of bottom bars	1	50
One big wheel	2	25
Two old Horse wheels	4	-

One bed and furniture	\$5
One thousand Dollars in cash	1000
One Iron candlestick	25
One pepper box	12½

Property belonging to Robert Hicks -

One Geography	3
One belt	10

Commissioner report in full { James Leore
Peter Conover
Thomas Nichols

For the subsistence of the family the ensuing year
To 113 dollars 50 cents month of Pork
To 327 dollars month of Lard
To 26 dollars 75 cents month of Beef
To 50 dollars month of wheat
To 80 dollars month of oats hay & fodder
\$597.25 The amount for the consumption
of the family which is to be deducted from
the whole appraisement given under our hands
as sworn commissioners date within

{ Peter Conover
James Leore
George Carlisle
Thomas Nichols }

Woodford County Feb February County Court 1813

The foregoing Inventory and appraisements
of the personal Estate of William Hicks
was returned in court and ordered to record

Teste John McHenry D. C. C.

Woodford County Oct December 16th 1812
agreed to an order of court of said county at
their last December Term in the commissioners
appointed to appraise the Estate of Thomas
Turnham deceased proceeded according to an
act of assembly in that case made and

37 provided to appraise said Estate and report as follows to wit	
Two tubs of salt and the tubs appraised	\$14 30
Fifteen pounds of Tallow	1 20
A large leather wheel	2 30
Two Reels	1 75
Saddled bridle and surringle	15
A buckboard	15
Four Iron Bars	7
Two candlesticks on Inkstands a marking Iron and four weights	1 75
Two crocks a pan two coffee pots and a coffee mill	2 30
A Tea board and a looking glass	4
Six flag bottom chairs	3
Box and tools	10
Three narrow axes a broad axe drawing knife and a foot adze	7
A Holster of Pistols	10
A hand saw	1 50
A tin gallon, quart a funnel and state	1 50
Two blind bridles	3
A bedstead and blanket	14 50
A bedstead and furniture	26
A pair of fire Irons and Decanter	2 37½
A kettle pot and oven	6 50
Two buckets a churn pail wash bowl & scire	2 25
Two crocks and a strainer	0 30
An oven a tea kettle a small kettle and grid Iron	5 35
Six whisky barrels	4 30
Three old flour barrels	0 37½
A wooden funnel and pail	37½
Two gudgeons a pair of hames two swin glebras stretcher and hammer	2 30

62 1812 Dec 31st To boarding Ambrose Wicks }
 10 $\frac{1}{2}$ months at 50 p^r year \$45 $\frac{1}{2}$ }
 1813 Jan 1st To balance due the estate on settle- }
 ment with the commissioners }
 13 3 =
 78 14 6
 43 19 -
 122 13 6

Supra
 1812 Dec 31st By balance due the said Estate }
 from last settlement - - - } 229 6
 By the line of the following negro slaves
 Negro man Will - \$75
 Do do Harry - 70
 Do Lad Minnie - 70 at Bucks
 Do woman Katy - 40
 Do girl Calah - 25
 Do boy Harrison - 18
 Do do Spencer - 15
 Do do Amsted - 13
 Do small do Joe - 8
 \$334 equal to \$100 $\frac{1}{4}$

We John Metcalf John R Ward and Samuel
 Oriscott commissioners appointed by the worship-
 ful county court of Woodford to settle the ac-
 count of the administration of the estate of John
 Wicks deceased having examined the annexed
 here found it correct and therefore admit it
 and do admit accordingly a balance in favour
 of the estate of forty three pounds nineteen shillings
 up to the 1st January 1813 John Metcalf
 John R Ward
 Samuel Oriscott

Woodford County Oct April County Court 1813

The foregoing report of commissioners
 to settle the accounts of the administration of
 the estate of John Wicks deceased was produced
 in court and proved to record

Teste John McKinney J^{us} C^{us}

In Obedience to an order of the most honourable county
 court for Woodford county at their February Term
 1813 we the undersigned commissioners after being
 duly sworn proceeded to allot to Elizabeth Wicks
 widow and relict of William Wicks deceased her
 dower and make distribution of the said Estate among
 the legates as follows to wit To the widow as her
 thirds of the real Estate Two hundred and two acres
 three quarters and twenty two poles of land and town-
 ed as follows to wit Beginning at a boxed high
 cry and bushy and running south 18 west 160 poles
 to a sugar tree and stone thence north 70 west 200
 to a hickory bushy and paupaw bush thence north
 18 east 160 poles to a stone in the line between
 W^{rs} Hicks and Nathaniel Harris thence south
 70 East 200 poles to the Beginning also a small
 piece lying between said Beginning and the road
 leading from Frankfort to Lexington which makes
 a perpendicular of 14 poles and a base of 66 poles
 and the following slaves to wit Sam at \$500
 Doctor at \$430 Isaac at \$230 Jane at \$330
 Monah at \$300 Venus at \$200 George at \$230
 and Robin at \$165 " 66 $\frac{2}{3}$ cents amounting to two
 thousand four hundred and thirty two dollars sixty
 six and two thirds cents and \$1139 $\frac{1}{4}$ 49 cents in
 money and debts due the Estate in the hand of the
 administrators we have also made distribution of the
 slaves and personal Estate between the legates agree-
 ble to said order as follows to wit To Philip McK
 who married Polly Wicks the following slaves
 to wit Joe and Robin at \$650 and \$247 $\frac{1}{4}$ 97 $\frac{1}{2}$
 in bonds in the hands of the administrators.

64 To Robert Hicks balb and Beck at 600 and
\$297" 99 3/4 in bonds in the hands of the admin-
istrators To Henry Downs who married Eliza-
beth Hicks till Parker and Sam at \$600
and 297" 99 3/4 in bonds in the hands of the
Administrators to Susanna Hicks Tab Sal-
and child at \$300 and 397" 99 3/4 in bonds
in the hands of the administrators To Ann
Hicks Tom and Sunny at 625 and \$272
" 99 3/4 in bonds in the hands of the admin-
istrators To Sarah Hicks John Mary and
Daniel at \$665 and \$232: 99 3/4 in bonds
in the hands of the administrators To Olivia
Hicks Eler Charles & Reuben at \$600 and
\$297" 99 3/4 in bonds in the hands of the
Administrators To Catherine Hicks Charlotte
Jason and Hulson at \$625 and \$272: 99 3/4
in bonds in the hands of the administrators
given under our hands and seals this fifth day
of April 1813 George Bulyle James Bond The McKidd
Woodford County sworn to before me
a Justice of the peace for the county aforesaid
this 5th day of April 1813 The Stinson JP

Woodford County 20th April County 6th ms 1813
The foregoing report of Commissioners
to divide the estate of William Hicks dec^d
was produced in court and agreed to be
Recorded Teste John McKimney jury cwc

65 I shew all men by these presents that I Virgil McKimney
in of the county of Woodford and state of Kentucky
do declare this to be my last will and testament in
manner and form following viz I give and bequeath
to my wife Chartha three negroes viz Sophia
and her child Charlotte and Maria also all the
household furniture which belonged to her before her
marriage which negroes and household furniture
is to be considered her right of Dower to my
Estate I give and bequeath to my Daughter Polly
one negro woman named Sunny and her son Charles
a feather bed and furniture one horse and saddle
worth one hundred Dollars. I give and bequeath
to my Daughter Chartha one negro woman named
Vina and her son Peter one feather bed and furniture
and one horse and saddle worth one hundred dollars
the horse and saddle to be paid them by my Dec^d
at their arrival to the age of 14 years I give to
my son Cyrus one negro woman named Phillis
and her son Sam Beck and furniture I give to my
son George two negro boys Dick and Spencer and
the interest of the negroes I have of my Fathers
Estate at my mothers death. I give to my son
Virgil two negroes Mary and Rachel and one negro
man named Sam now in the possession of Henry
Baldwell and further I give to my son Cyrus one
negro woman named Aggy I wish all my landed
Estate to be sold and equally divided among my
children at their marriage or at their arrival
to the age of eighteen years of the girls and twenty
years of the boys giving two years credit for all

142 By Cash paid Robert Trimble Esq for his services as an attorney at law in the same business receipts filed 25 " 0

By Cash paid same to Thos. Galewood 5 " -

By Cash paid John Williams on Bond receipts filed 4 " 25

By Cash paid James Abrast on Bond receipts filed 163 " 35

By Cash paid motion on Bond receipts filed 75 " 75

By Cash paid Annus Morris Estate receipts filed 8 " 17

By Cash paid John Williams receipts filed 4 " -

By Cash paid John Fulkerson receipts filed 10 " 61

By Cash paid John Whitham receipts filed 5 " -

By Cash paid John Wilson receipts filed 10 " -

By Cash paid Meredith Wright on an Bond receipts filed 580 " 75

By Cash paid to David Rice receipts filed 14 " 61

By Cash paid Elfr Montgomery for his fee 4 " 96

By Cash paid Geo. Freeman acc'd filed 4 " -

By Cash paid Robt. Clark for attendance and fees not filed 1 " 17

By Cash paid Chittin Allen same receipts filed 1 " 17

By Cash paid Paul & son for formations acc'd filed 30 " 70

By Cash paid Hugh Leath receipts filed 2 " -

By Cash paid James White acc'd filed 4 " -

By Cash paid John M'Gee acc'd filed 2 " 80

By do do Mary Strode 5 " -

By Cash paid Fowler & Telford acc'd receipts filed 32 " 80

By Cash paid Geo. Brown receipts filed 10 " -

By Cash paid Robert Galewood 14 " -

By Cash paid J. Traller for coffin 7 " -

By Cash paid John Johnson acc'd filed 3 " 30

By Cash paid James A. Smith for his fee 5 " 32

By Cash paid James Lamkin acc'd filed 1 " 25

By Cash paid Wm. Ansely for property sold 1 " -

By Cash paid James White receipts filed 7 " 30

By Cash paid Robert Galewood over filed 4 " -

By Cash paid on suit agt Thos. Galewood & Court 328 " 01 certificate filed

By Cash paid James Lamkin receipts filed 13 " -

143 By Cash paid York for hauling receipts filed 50 " 75

By Cash paid Singleton & Laper for taking doct^r Brown's Deposition 2 " 00

By Cash paid in costs of suit in the Montgomery Co against Olson acc'd filed 312 " 71

By Cash paid Thomas Stinson by the hands of John Williams receipts filed 6 " -

By Cash allowed the Est^t for his services 75 " -

By Cash paid Chas. Corn 6 " -

By Cash paid John McKenny for his fee 2 " -

George Woolfolk Richd. Lane John Graves

Worcester County Oct February County Court 1814

The foregoing report of commissioners to settle the accounts of James Hargood Executor of Charles Hargood deceased was produced in Court & ordered to stand as the Court is satisfied with the same.

Test John McKenny J. C. W.

1813 Nov^r 13th State of Kentucky Worcester County

Surveyor for the heirs & Representatives of William Hicks deceased three tracts of land in one inclusive survey and bounded as follows Beginning at A (in the corner of the tract hereto annexed) a buckeye corner to Nathaniel Harris A 70.25 W 284 ps to B, a buckeye buckeye & Court A 212 W 238 ps (C) a stake and white ash corner to Hapkins A 71 E 147.2 poles to D, a white ash buckeye & buckeye corner to Richard Gray A 113 W 79.2 poles to a locust post two white buckeyes & dead mulberry corner to Gray & Brum same corner with Brum line 131-230 poles to E, a stake corner to Brum & Rler Covenhoven A 70.30 E 233-6 poles to F a stone corner to John Armistongs 8 acres and with two of his lines A 70.30 E 36 to G a stone A 70.30 E 36 poles to H, a stone A 19.35 E 109.5 poles to I, a stake & honey locust corner to Charles F. Raymond shared with two of his lines A 67.5 W 68.5 poles to K, three small eagles 2 down corner to Gray & Payne A 19 E 81.2 poles to L, two buckeyes

and hickory corner to Payson or William Adams
line at 71° 23' 10 1/2 poles to (M) a stone corner to
said Adams and David Harris's line to the Beginning
Containing 761° 3' 24 poles. Richard Fox Esq.

Division of land between the heirs of William
Hicks dec'd made by Richard Fox Esq. & Herman Downer Esq.
Note two hundred acres of this inclined survey being
allotted to Mrs Hicks widow of said decedent as her
Dower land including the mansion house. The balance
to wit 261° 3' 26 being divided among six Legates
make 93° 2' 24 to each and there being another tract
of 136 acres part of Charles Lewis's military survey
and only one other legated being entitled to distribution
of the land (Mr Philmon Price having had provision
in this case) this tract affords said Legates part
of 93° 2' 24 and an overplus of 4° 2' 16 to be
sold and the monies arising therefrom to be appor-
tioned among the said Legates respectively according to
the apportionment hereto annexed. The said dower of
200 acres and the shares of the said Legates & representa-
tives being laid off numbered & divided by lottery
The following is the true miles and bounds thereof
and the annexed certificate plate page 6 shows each
tract with the proper names inserted.

Surveyed for Mrs Hicks widow & relief of William
Hicks dec'd 200 acres of land Beginning at a
buckeye corner to estate Harris at 71° 23' 10 1/2
poles to (1) three sugar trees corner to John Hicks
at 18° 10 138 poles to (2) three papawes & ash corner
to Robert Hicks at 71° 23' 10 1/2 poles to (3) a large
sugar tree at 18° 10 138 poles to the Beginning

Rich Fox Esq.

Surveyed for John Hicks 93° 2' 24 designated
in the certificate plate by No 1 Beginning at
3 three sugar trees corner to Mrs Hicks dower at

71° 23' 10 1/2 poles to B a hickory buckeye and Henry
Downs at 20° 30' 10 1/2 poles to G a hickory buckeye
& brace corner to Henry Downs at 71° 23' 10 1/2 poles
to (E) four papawes & stake (1 pole at 67° 8' from a
white ash) at 18° 10 176 poles to (F) three papawes
and white ash corner to Mrs Hicks dower and corner
138 poles = 175-6 poles to the Beginning Rich Fox Esq.
Surveyed for Robert Hicks 93° 2' 24 designated by
number (2) Beginning at (3) a large sugar tree
corner to Mrs Hicks dower at 71° 23' 10 with her
line 202 poles to (2) three papawes & white ash
at 18° 10 176 poles to (3) four papawes & stake (1 pole
at 67° 8' from a white ash) corner to John Hicks
at 71° 23' 10 86 poles to (4) a stake 9 feet east from
a sugar tree corner to Henry Downs & with four of
his lines at 18° 10 142 poles to (5) a stake 12 feet 8 1/2
10 from a white ash) at 71° 8 66 poles to (6) a stake
at 19° 10 1 pole to (7) a stake (2 poles at 71° 8 from a
white ash Hickory & buckeye corner to Gray) at 71° 23'
144° 8 poles to M a stone corner to William Adams
at 18° 8 72 poles with his line to the Beginning
Rich Fox Esq.

Surveyed for Henry Downs 93° 2' 24 designated by No 3
Beginning at (10) a stake 2 feet 2 1/2 from
a hickory corner to Catharine Hicks at 71° 23' 10 21 1/2 poles
to M a stone corner to Robert Hicks & thence with four
of his lines at 14° 8 176 poles to (4) a stake 2 poles 570
8 from a white ash hickory & buckeye corner to Gray
at 18° 8 1 pole to (5) a stake at 71° 10 66 poles to (6)
a stake 12 feet 8 1/2 10 from a white ash at 18° 8 142
poles to (7) a stake 9 feet east from a sugar tree
at 71° 23' 10 80 poles to (9) a hickory buckeye &
brace corner to John Hicks at 20° 30' 10 33 poles
to (E) a stake & white ash corner to Hopkins at 71° 8 with
his line 147 poles to (D) a white ash hickory &

146 buckeye corner to Gray S 19 10 63 poles to (D) a
broaden & buckeye corner to Olivia Hack, S 7 E
177.5 poles with her line to (H), a black Locust stump
in a field at 19 8 61-9 poles to the Beginning.

Rich. P. Fox S.M.C.

Surveyed for Oliver Hicks 93^a 2⁵ 3⁴ designated by
No 4 Beginning at (12), a horsehair & buckhorn
corner to Henry Downs S 19° 10' 54" 9 ps to (13) a sugar
tree corner to Sally Hicks and with three of her
lines S 71° E 108.5 poles to (14) a stake between a
buckhorn & Honey Locust S 19° 10' 6" 9 ps to (15) a
stake S 71° E 69 poles passing between two springs
to (16) a black Locust S 19° E 124 1/2 poles to 11 a
black Locust stump in a field another corner to Saml
Downs thence with his line S 71° 10' 17" 5 poles to
the Beginning Rich^d Goodlett

Rich^d Ford M^e

Sprunged for Sally Hicks 93.^a 2.^a 24 designated on
 the connected plat by No 5 Beginning at (13) a
 sugar tree corner to Olivia Hicks S 19° 10' 110.1 poles to
 (E) a stake corner to Peter Kovenhove S 70° 31' E
 177.5 poles to 17 a stake (10 feet S 60° W from a
 Honey Locust) corner to Catharine Hicks N 19° E 45.2
 poles to (15) a black locust corner to Olivia Hicks
 N 71° 10' 69 poles to sapling between two springs to
 (15) a stake ~~at~~ at 19° 8' 69.6 poles to (14) a stake
 between a Buckeye & Honey Locust N 71° 10' 108.5
 poles to the Beginning Rick. For SMC

Rich^d For Sme

Surveyed for bathairnd Hicks 93² 2⁷ 24⁷ designated in the plat of by No 6 - Beginning at (10) a stake 2 feet 78¹⁰ from a highway corner to Henry Brown on William Adams line and running thence S 19° 10 22 69 poles to (17) a stake 10 feet 160 00 from a Henry Brown corner on Covenhoven line and with it S 77° 30 E

47

38. 1 poles to E a stone corner to John Adams strong &
acres and with two of his lines at 17. 15 & 36 poles to G a
stone corner at 70 1/2 & 36 poles to H a stone at 17. 15
& 109 1/2 poles to I a stake & Honey Locust corner to
Charles H Payne & with two of his lines at 69 1/2 w 88 poles
to K a stake & small sugarbush (two sugarbush grow
along the road) to Gray at 15 & 51 1/2 poles to L two Buckeyes
and Hickory on Williams Adams line & with it
at 71 w 23 1/2 poles to the Beginning Rich^d Stone Bros

Rich^d Stone Mrs

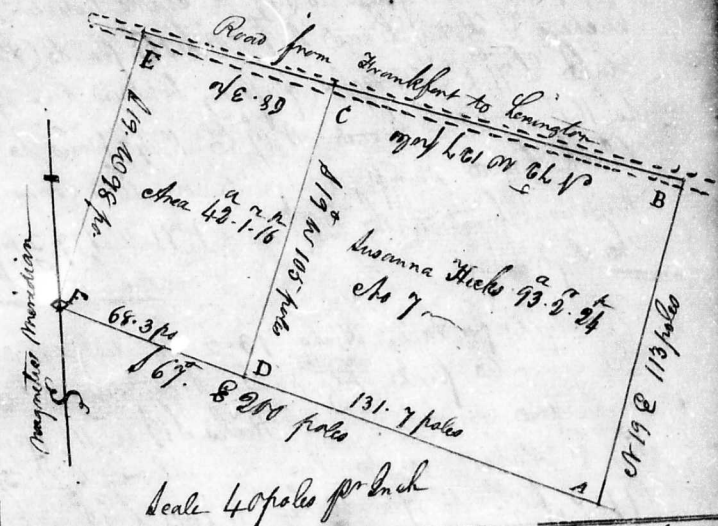

Surveyed for Susanne Hicks 9th 5.54 designated on the above plat by No 7.
part of Charles Lewis's military survey Beginning at A a white oak &
hickory corner to John Ford on Harpers line at 19° 21 1/2 po to B a stake
in the road from Frankfort to Lexington corner to Lewis Ancholet 79
to 127.7 po to C, a stake in the middle of the road standing 2 po
at 68 from a sugar tree & box elder on the south side of said road
at 19 no 105 po to D, a stake 2 po 130 no from a sugar tree 67th
131.7 poles to the Beginning
Rich^d Fore DME

Pick Fore AME

Woodford County November 27th 1813
 Surveyed for the heirs & representatives of William Hicks
 deceased 42^{1/2} A. R. to part of said Hicks survey of 136 acres begin-
 ning at (D) (in the preceding plat) a stake 2 po 130
 W from a sugar tree on Harpers line corner to Susanne
 Hicks and running thence with her line N 19° E 100 poles
 to C a stake in the middle of the road 2 poles

for the division of lands and having been called upon by the heirs of William Hicks deceased to divide certain lands lying in said county of which the said William Hicks in his life time was seized and possessed of and which said lands are described by the foregoing certificates of boundary and plats. We the said commissioners met upon the said lands on the 16th day of November & then proceeded (continued from day to day) to view and lay off the same into seven shares or lots agreeable to the foregoing certificates of surveys or boundary and plats (200 acres the Melisious Downer herein before described excepted) We then proceeded to value said lots or shares in their relative comparison to each other & Susanna Hicks Catharine Hicks and Robert Hicks Henry Downs Olivia Hicks Sally Hicks and Ann Hicks heirs of the said deceased being present as also David Harris guardian for such of them as are infants we proceeded by lot to divide the said lands which are herein before described by certificates of boundary and by plats between them the said Susanna Catharine Robert Olivia Sally Ann and Henry Downs & Elizabeth his wife the Elizabeth Hicks Children and heirs as aforesaid each drawing for themselves respectively. The said Children and heirs and David Harris guardian as aforesaid having previously agreed among and between themselves to pay & receive the difference that we the commissioners should appraise and decide to be between the value of the several lots or shares herein before described as laid off by us for division amongst them We accordingly decided and settled the value and value or difference between the said seven dividends of the said land before we subjected

the same to be lotted or drawn for by them respectively and by allotment and drawing before mentioned we have divided the said lands before herein described (except the said downer of 200 acres) and have given and do hereby give and assign to each of the said seven heirs in this division as followeth to wit To said Ann Hicks the tract of 93 acres 2 roods & 24 poles herein before described by boundaries and by plat as no 1 (number one) and the said Ann is to receive from the administrator of the said deceased Estate one hundred and sixty one dollars being in our opinion what will make the said tract or lot number one a fair and equal dividend of the lands aforesaid in its comparison value with the said other dividends To said Robert Hicks the tract of 93 acres 2 roods & 24 poles herein before described by plat and by Certificate of boundaries no 2 (number two) and the said Robert Hicks is to pay the said administrator for the purposes aforesaid eighty eight dollars and fifty five cents. To Henry Downs & Elizabeth his wife late Elizabeth Hicks the tract of 93 acres 2 roods & 24 poles herein before described by plat and by Certificate of boundaries as no 3 (number three) and the said Henry & wife is to receive from the said administrator thirty six dollars and fifty cents to make this division equal and fair as aforesaid To Olivia Hicks the tract of 93 acres 2 roods & 24 poles herein before described by plat & by Certificate of boundaries as no 4 (number four) & she is to pay the said administrator two hundred dollars for the purposes aforesaid in this division. To Sally Hicks the tract of 93 acres 2 roods & 24 poles herein before described by plat and by Certificate of boundaries as no 5 (number five) To Catharine Hicks the lot or tract of 93 acres 2 roods & 24 poles therein before

described by plat and by certificate of boundary as No 6 (number six) and she is to be paid by the said administration one hundred and eighty dollars to make up an equal and fair division as aforesaid. To Susanna Hicks the late tract herein before described by plat & by certificate of boundary as No 7 (number seven) and she is to pay the said administration for the purpose of said and equal division aforesaid eighty eight dollars seventy five cents. We hereby further certify that we did not direct the tract of forty six acres and more & sixteen poles therein before platted and described by its boundary nor allot it to any of the said heirs given and exhibited under our hands & seals this 7th day of February 1814

Richard Fox
Herman Bowman ^{com^{rs}}

Account, between the above named heirs under the division to wit

Or to admit	Robert Hicks	\$88.75	Thomas Hicks	\$161.00
	Oliver Hicks	200.00	" Henry Downs	36.50
	Susanna Hicks	88.75	Catharine Hicks	180.00
		<u>377.50</u>		<u>377.50</u>

Woodford County Court Richard Fox & Herman Bowman Esqs. came before me a Justice of the peace in and for the county aforesaid & under oath that they give as commissioners for the division of lands) justly & impartially divide the lands of William Hicks deceased among the heirs & representatives of said deceased to the best of their skill & judgment given under my hand this 7th day of February 1814

L. Williamson Jr

Woodford County Feb^{ry} 20th February County Court 1814
The foregoing report of commissioners dividing the lands belonging to the Estate of William Hicks deceased among the heirs of said dec^d was presented in Court & ordered to record
Teste John McManney Jave

Woodford County Let me the undersigned commissioners in obedience to an order of the county court for said county made at their October Court 1813 directing us to attend to Sarah Brittenson widow and relict of John Brittenson deceased her dower in his personal estate and to divide the residue among his heirs & representatives. report as follows, that we met at the house of Mrs Brittenson on the 17th of November 1813 for the purpose aforesaid but in consequence of an agreement between the widow & heirs of said decedent (whereby she agrees to receive and they to give a certain sum of money annually during her life in lieu of her dower in the personal estate) we did not allot her dower and proceeded to divide seventeen slaves belonging to the estate of said deceased among his heirs. 1st we valued the said seventeen slaves to the sum of \$4535 as will appear hereafter as they are distributed by name & their separate valuation annexed and divided them in the manner following 2nd we allotted to John W Smith (who intermarried with Harriet Brittenson one of the daughters of said dec^d) George a negro man valued at \$250 Beverly a negro boy valued at \$275 and Bently a negro boy valued at \$225 amounting to \$750 which exceeds the sum of \$617 each child's proportion \$103. 3rd we allotted to John & Brittenson Frederick a negro boy valued at \$350 & Jimmy a negro woman & her child Morris valued at \$275 amounting to \$625 which exceeds his proportion \$8. 4th we allotted to Thomas & Brittenson Isaac a negro man valued at \$500 & Washington a negro boy valued at \$150 which exceeds his proportion \$33. 5th we allotted to John McManney Esq (who intermarried with Margaret Brittenson one of the heirs of said dec^d & to whom Henry Brittenson another of the heirs has transferred his interest in said estate) Bob a negro man at \$220 Ambrose a negro man valued at \$10 & Adam a negro