

105

Small black those west 78 poles to a strike on the boundary line
of the 100 those north 42 poles to two small dipping rocks on the N
of the line and another corner to the 100 those East 78 poles to the
boundary line and ^{having} a line and a small house and was attested to
James Ogden &c

Lot 108 Beginning at three small black poles south east corner to Lot 107 running west with that Lot 98 pole to his corner a stake thence South with the East boundary line of Lot 108 Lot 106 and part of the line of Lot 103 1/2 poles to a stake thence East 98 poles to three small black poles on Adams line and with it north 1 1/4 poles to the Beginning containing five acres and one half of an acre and was sold to James Adams

Ed. 109 Beginning at three small part Cakes South east corner of Ed. 108 running thence west 78 poles to a stake standing on the East side boundary line of Ed. 103 running thence south 34 poles to a stake thence S 53 E 15 1/2 poles to the Beginning containing twenty five Acres and was Att'd to Chas. Ogden

Lot 101 Beginning at a black Oak Standing on Adams line
and north east corner to Lot 104 running thence north 10 poles
to a stake by Jordan south east corner to Lot 109 thence with his
line N 87° E 97 1/2 poles to a stake corner to Lot 109 on the East
boundary line of Lot 109 thence South 25 1/2 poles to a rock north west
corner to Lot 104 thence East 48 poles to the Beginning containing
thence and one half Acre and was attested by Polly Cydars

Lot 1st Beginning at three high trees comes to Adams on Hanstborough
 line running North W to a black oak comes Lot 1st 10 then e west
 18 poles to a rock on the east boundary line of Lot 1st 2 thence South
 16 poles ~~thence South~~ to a stone four feet west of an elm marked as
 a corner standing on Peter Hanstboroughs line and with it S E 18 poles
 to the Beginning containing pasture Acres and was attested to all by
 Agoston

Wm Wilson S. L. C.

Asquable to an Order of the County Court of Logan County Sep^r term to us divided. On the 5th day of Sep^r 1876 we went on the lands of the heirs of John Caplan Ltd and divided and made the above described division and allotment among the different heirs of said land.

Sand Millen Court
 Henry Saint Court
 David King Court

Logan County The Alabama land begun and had for Logan
County at the Courthouse in Ripleyville on the 5th day of November
1827. The within Division of the Land Estate of John Ogden deceased
was exhibited in open Court approved by the Court and ordered to be recorded
In Testimony of which and that the same together with this certificate
shall truly record in my Office

I Account to ^{his} hand And date above

Spencer and Co
(1851)

106

Conrad
Christoph.
Lied
Linné

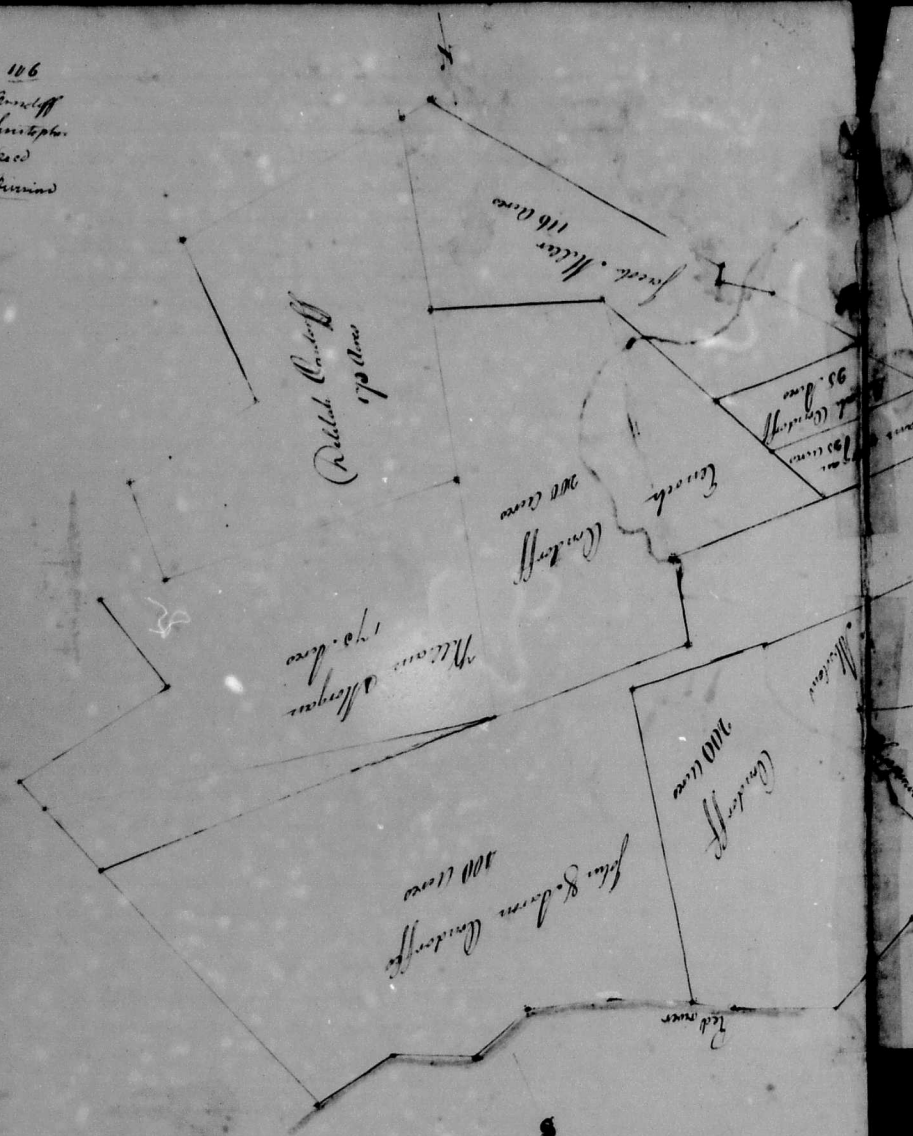

We the undersigned Executors of the last will & Testament of Christopher Condorff
have according to the requisitions of said will divided the real estate of said
Condorff deceased as the within plat exhibit and made conveyances to each of
the two for their respective parts as set forth in the within plat and to any exhibit
to the Logan County Court the within plat & conveyances to be recorded in
said Office
June 4th 1827
John Condorff Esq
Caron Condorff Esq
Hiram Morgan Esq